

# Pressing On

2023 ANNUAL REPORT



**PROVIDENCE**  
CHURCH



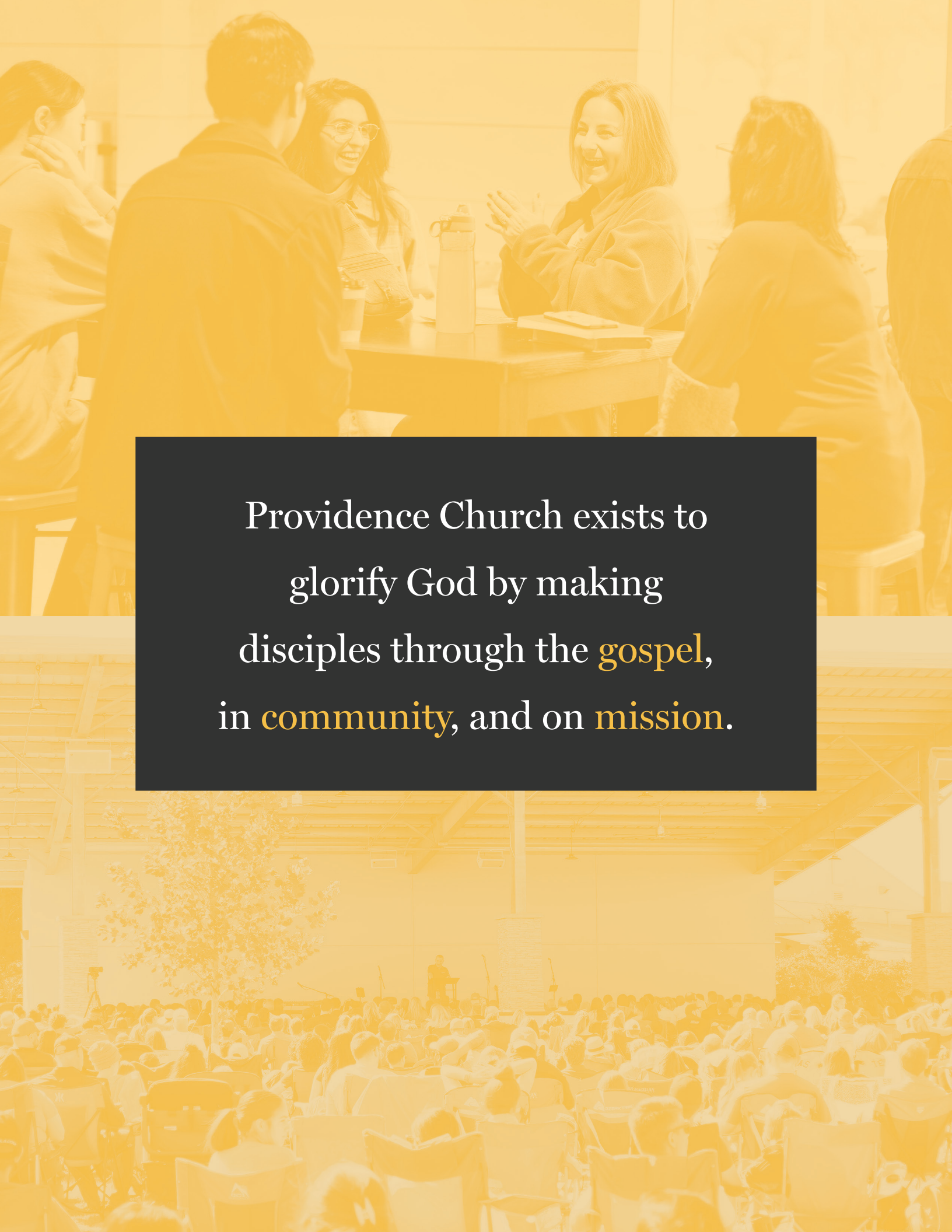

Providence Church exists to  
glorify God by making  
disciples through the **gospel**,  
in **community**, and on **mission**.

A woman with long blonde hair is singing into a microphone on a stage. Behind her, a man is playing an acoustic guitar, and another person is partially visible. The scene is dimly lit, with stage lights visible in the background.

OUR VISION IS TO SEE

8

CHURCHES PLANTED OR REVITALIZED

20

MISSIONARY UNITS SENT AMONG THE UNREACHED

140

ACTIVE COMMUNITY GROUPS

by 2032







# “I press on toward the goal for the prize of the upward call of God in Christ Jesus.”

**PHILIPPIANS 3:14**

---

Friends,

I am constantly amazed by all of the exciting things God is doing in and through our church. This past year has been just another example of how he is working in our midst and providing for us along the way. The momentum continues to build each and every week. But what excites me most is not simply the new faces each Sunday or the new facilities we're preparing to build - it's the new levels of deep discipleship that have been growing in 2023.

Over the past two years, we've sought greater clarity about where we are heading as a church. 2023 will be remembered as a time when we took giant leaps in our efforts toward our ten-year vision and pressed on toward those God-given goals. It's the year when we better defined what it means to grow in Christ. It's the year we introduced new ways to mature in the spiritual disciplines. It's the year we took new strides in developing healthy leaders.

As you browse through this report, I hope you will be as excited and grateful as I am about how the Lord is using Providence Church for his glory and his kingdom.

In Him,

A handwritten signature in black ink, appearing to read 'Afshin'.

Afshin Ziafat

Lead Pastor, Providence Church





46

PEOPLE BAPTIZED

143

NEW MEMBERS ADDED



498

PEOPLE IN ACTIVE SERVICE ROLES





715

PEOPLE IN COMMUNITY GROUPS

9

NEW COMMUNITY GROUPS LAUNCHED



6

ACTIVE MISSIONARY UNITS



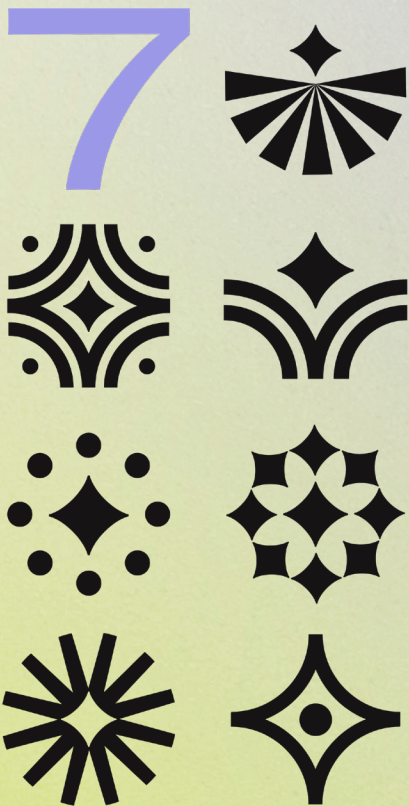

## CHARACTERISTICS OF A MATURE DISCIPLE

What constitutes a mature disciple? What are some of the fruits that can be easily observed by others in the church from someone who is maturing in Christ? How can we better help an individual identify areas where growth is still needed?

In August, we introduced the Seven Characteristics of a Mature Disciple, drawn largely from the principles outlined by Paul in 1 Thessalonians 1:4-10. Designed to serve as the bullseye for our discipleship efforts, they help individuals better assess how well they're personally growing in their relationships with Christ.

To aid the congregation in better understanding their current discipleship needs, we also introduced the Spiritual Health Snapshot, a thoughtful self-assessment that allows each individual to see where they need to grow and discover the best resources to help them take their next steps.

LEARN MORE ABOUT THE SEVEN  
CHARACTERISTICS AND TAKE THE  
SPIRITUAL HEALTH SNAPSHOT AT  
[PROVIDENCEFRISCO.COM/MATURITY.](https://providencefrisco.com/maturity)



Spiritual Health  
Snapshot





# Embracing Authentic Christian Community

Our dedication to community is so central to our identity that it's a key part of our mission statement. We believe that balanced and holistic discipleship is only accomplished in environments where people feel the freedom and vulnerability to be known and know others.

The fullest expression of Christian fellowship at Providence happens in the context of 50+ community groups that meet in homes across Frisco, Little Elm, McKinney, Plano, Celina, and Prosper. As Providence continues to grow, we must continue maintaining healthy community. In 2023, nine new groups were launched to provide meaningful fellowship for more people.

As part of the ten-year vision, Providence is prayerfully seeking to see 140 active community groups by 2032 to accommodate the church's anticipated growth.

**LEARN MORE ABOUT COMMUNITY GROUPS AND REGISTER  
TO JOIN ONE AT [PROVIDENCEFRISCO.COM/GROUPS](https://providencefrisco.com/groups).**

715

**PEOPLE IN  
COMMUNITY GROUPS**

9

**NEW GROUPS LAUNCHED**

140

**ACTIVE COMMUNITY  
GROUPS BY 2032**



# Growing in Prayer and Bible Intake Through Huddles

If you ask most Christ-followers where they continually struggle in their relationships with Jesus, they will frequently mention two areas where they need growth - prayer and personal Bible study. Seeing this need in our own congregation, a small team came together in late 2022 to address the issue, eventually leading to the launch of Huddles in August of this year.

Huddles provide a new discipleship opportunity for men and women to gather together and intentionally develop these important spiritual habits. As groups of 5-7 people, they choose a Bible-reading plan, commit to journaling daily, and follow a specific format for observing, interpreting, and applying God's Word to their lives. Along the way, they follow a specific liturgy of prayer in a customized journal. As participants do this together, they experience meaningful accountability and develop habits that will serve them for years to come.

**NEW HUDDLES LAUNCH IN JANUARY. LEARN MORE AND REGISTER TO JOIN ONE AT [PROVIDENCEFRISCO.COM/HUDDLES](https://providencefrisco.com/huddles).**

20

HUDDLES LAUNCHED

85

HUDDLE PARTICIPANTS



# Engaging Young Adults

2023 has been a time of accelerated growth and pace with Providence Young Adults (PYA). In addition to seeing Tuesday night attendance grow from an average of 20 to 70 people per gathering over the past two years, they also moved from bi-weekly to weekly services. As PYA reaches more young adults, the leadership team has also grown significantly to include more training and discipleship of small group leaders.

In addition to these important gatherings, Providence has also established a growing presence at Collin College. On Wednesdays, the team sets up a table on campus to engage students with the gospel. They also host weekly free lunches and Bible studies for students interested in learning more about Christ. Within the past year, multiple students have visited Providence as a result of this ministry and two received Christ. Now that the University of North Texas has opened its campus in Frisco, we're already working toward establishing this same presence there.

**LEARN MORE ABOUT PYA AT  
[PROVIDENCEFRISCO.COM/PYA](https://providencefrisco.com/pya).**





# Empowering Parents to Cultivate Christ- Centered Homes

244

AVERAGE SUNDAY MORNING ATTENDANCE

155

BACKYARD KIDS CLUBS PARTICIPANTS

5,000+

DUM-DUMS DISTRIBUTED

1,000+

NERF BULLETS LAUNCHED

There are 168 hours in a week. On average, kids only spend one of them in a classroom at church. In that hour, they can feel loved. They can encounter the gospel. They can learn more of God's Word. But true discipleship can't happen in such a short timeframe. By God's design, the primary gospel influence in children's lives is their parents.

It's for this reason that our amazing team does everything they can in Providence Kids to provide a safe, warm, and gospel-centered environment on Sunday mornings. It's also why we aim to empower parents to cultivate Christ-centered homes. In 2023, this meant offering chances for families to bond through events like game nights, serve through Backyard Kids Clubs, and open God's Word together every day through original curriculum and resources designed for the home.

While all of this has happened, the team has prepared behind the scenes to introduce *His Kingdom Come*, a new family devotional that takes parents and kids through the entire story of the Bible in one year, exploring God's plan for salvation and redemption along the way.

LEARN MORE ABOUT *HIS KINGDOM COME*  
AT [HISKINGDOMCOME.NET](https://hiskingdomcome.net).

GET CONNECTED WITH PROVIDENCE KIDS AT  
[PROVIDENCEFRISCO.COM/KIDS](https://providencefrisco.com/kids).



YS WE WILL SING YOUR PRAISE  
D. OH LORD OUR GOD

REIGN

FOR ENDLESS DAYS WE WILL SING YOUR PRAISE  
OH LORD OUR GOD

# A Generation of Kingdom-Minded Disciples

2023 was a turning point in the life of Providence Students. It was the year we hosted our own camp for the first time, where 7th-12th graders retreated from the demands around them to spend time in worship, teaching, and fellowship. It was also the year of a groundbreaking FOCUS Weekend, new summer discipleship groups, and an exciting year at Ignite on Wednesday nights.

As the student ministry has grown, so has The Bridge, a special gathering of 5th and 6th graders on Sunday afternoons designed to prepare them for the transition into their teenage years. This fall marked the largest group of preteens to come into the ministry yet.

LEARN MORE ABOUT PROVIDENCE STUDENTS AT  
[PROVIDENCEFRISCO.COM/STUDENTS](https://providencefrisco.com/students).

95

STUDENTS AT FOCUS  
WEEKEND

82

AVERAGE IGNITE  
ATTENDANCE

99

STUDENTS AT CAMP

52

AVERAGE ATTENDANCE  
AT THE BRIDGE







# Ministry to Men

40

**AVERAGE MEN'S BREAKFAST ATTENDANCE**

65

**GUYS AT THE MEN'S RETREAT**

The Men of Providence developed new rhythms of fellowship in 2023. We kicked off with the men's retreat in January at Sky Ranch. This year also included monthly men's breakfasts where guys studied the Armor of God over the course of the year.

# Ministry to Women

100+

**LADIES AT WOMEN'S NIGHTS OF WORSHIP**

48

**LADIES AT THE WOMEN'S RETREAT**

This year, women throughout the church came together for gatherings, building cross-generational relationships through Bible studies, coffee dates, and the annual retreat. This year we also introduced two nights of worship, led by women for women.





# Developing a Global Heart for God's People

It's easy to develop a very small view of the world and our role within it. But the global Church is much bigger than we realize. Likewise, the need for more missionaries is much greater than we often imagine.

Today, over 42% of the world population is still considered unreached, lacking any missionaries, accessible Bible translations, or local communities of believers within their midst. These people often exist in areas that are extremely remote or simply dangerous to engage. As part of our ten-year vision, Providence is seeking to send 20 missionary units, specifically among these unreached people groups.

As we continued to develop future missionaries here at home in 2023, multiple short-term teams were sent to areas in Asia to explore future landing spots for Providence workers, learn more about our outreach partners on the ground, and care for the missionaries we've already sent.

In 2024, more opportunities are coming to gain exposure, learn more about what it means to serve as a missionary, and partner with global Christians to advance the gospel.

**LEARN MORE AT [PROVIDENCEFRISCO.COM/MISSIONS](https://providencefrisco.com/missions).**

3

**VISION & CARE  
TRIPS SENT**

42

**GOSPEL OUTREACH  
TEAM PARTICIPANTS**

6

**ACTIVE MISSIONARY  
UNITS CURRENTLY SERVING**

20

**MISSIONARY UNITS BY 2032**





# ENTRUSTED — & SENT —

We've been entrusted with the gospel and our resources and placed in a growing region. As we embrace our ten-year vision, we face serious space constraints. In 2021, Providence embarked on an ambitious initiative to address these limitations. This includes:

**A new 1,200 seat worship center and commons** that allows us to better scale the number of Sunday worship services and reach the growing population more effectively.



**A renovated student space** that will unlock greater opportunities for ministry to middle and high school students.

**A complete translation of the New Testament** among the forest-dwelling Tenebre people so they can hear the gospel in their native language.

**An expanded children's area (Phase Two)** that will provide more classrooms for preschool and elementary-age kids on Sundays.

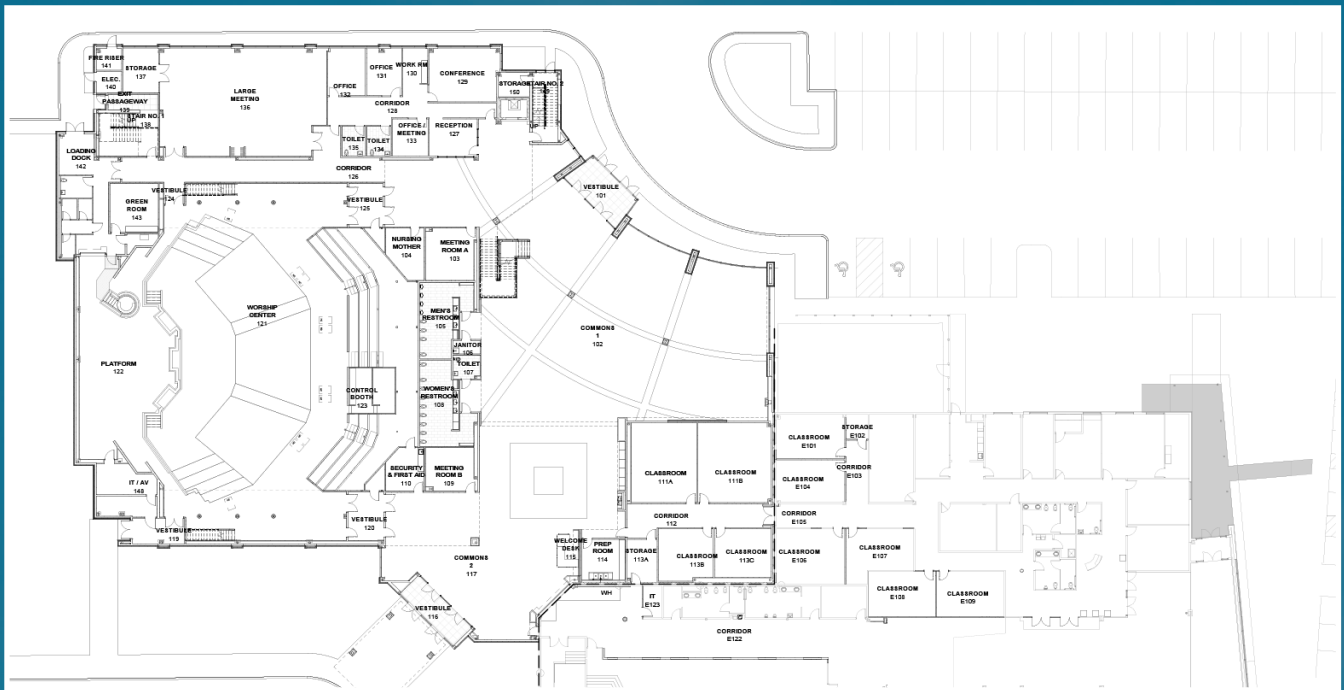

Due to rising construction and labor costs, the expenses for the project have continued to rise, creating a funding gap. In order to address this, we decided to reduce the cost by eliminating the renovation work for our new student space and cutting the additional administrative areas that had been planned behind the new worship center. This reduced our expenses by \$1.6 million.

Despite these changes, we were left with a \$2 million funding gap. Thanks to the generosity of people like you, \$1.3 million in donations have recently come in, helping us address this issue. An additional \$700,000 in contributions will allow us to move forward with the reduced version of the project. A total of \$2.3 million will allow us to complete the project without the proposed architectural cuts.

It will take all of us to close this gap and move forward with the project. If you have not made a commitment to Entrusted & Sent, please consider making one. If you've already committed, we're grateful for your generosity. Some people may be able to increase their commitment. If that's you, we would be grateful for your additional support.

## Financial Overview

<b>CONSTRUCTION COSTS</b>	<b>\$24 MILLION</b>
<b>CAMPAIGN DOLLARS</b>	<b>\$7.4 MILLION</b>
<b>CASH CONTRIBUTION</b>	<b>\$3.5 MILLION</b>
<b>BORROWING</b>	<b>\$9.5 MILLION</b>
<b>INITIAL DELTA</b>	<b>\$3.6 MILLION</b>
<b>ARCHITECTURAL CUTS</b>	<b>\$1.6 MILLION</b>
<b>RECENT GIFTS &amp; COMMITMENTS</b>	<b>\$1.3 MILLION</b>
<b>FUNDS NEEDED TO RESTORE CUTS</b>	<b>\$2.3 MILLION</b>

**LEARN MORE, DONATE, OR MAKE A  
COMMITMENT AT [ENTRUSTEDANDSENT.COM](https://entrustedandsent.com)**



## **ATTENDANCE & ENGAGEMENT**

AVERAGE COMBINED ATTENDANCE	1,122
AVERAGE ADULT ATTENDANCE	878
AVERAGE KIDS ATTENDANCE	244
TOTAL MEMBERSHIP	821
MEMBERS ADDED THIS YEAR	143
TOTAL STARTING POINT ATTENDANCE	108
TOTAL MEMBERSHIP CLASS ATTENDANCE	146
INDIVIDUALS IN ACTIVE SERVICE ROLES	498
INDIVIDUALS IN COMMUNITY GROUPS	715
BAPTISMS	46

## **2023 GIVING & EXPENSES**

GENERAL GIVING*	\$3.93 MILLION
ACTUAL EXPENSES*	\$3.12 MILLION
BUDGETED EXPENSES	\$3.6 MILLION

\*PROJECTED THROUGH DECEMBER 31 BASED ON CURRENT TRENDS









**PROVIDENCE**  
CHURCH

5625 PRESTON ROAD | FRISCO, TX 75034  
[PROVIDENCEFRISCO.COM](http://PROVIDENCEFRISCO.COM)

COPYRIGHT © 2023 PROVIDENCE CHURCH  
ALL RIGHTS RESERVED